

SERVICE OFFSETS

Street	Gas	NDW	Water	Comms	Elec.	Lighting	Sewer
SANDALWOOD CRESCENT (Ch218 - Ch491)	-	2.50 S	3.00 N	1.85 N	2.60 N	0.90 BOK	N/S 1.00
SANDALWOOD CRESCENT (Ch507 - Ch513)	-	2.50 E	3.00 E	3.00 W	1.10 W	0.90 BOK	E 1.00
MARANTA WAY	-	2.50 E	3.00 E	3.00 W	1.85 W	2.60 BOK	W 1.00(E)
KADAMBA LANE	-	5.10 W	5.50 W	3.80 E	1.20 -	-	N 2.50(E)

SERVICE OFFSETS ARE MEASURED (m) FROM THE TITLE BOUNDARY UNLESS OTHERWISE SPECIFIED
 * SERVICE OFFSETS ARE MEASURED (m) FROM BACK OF KERB
 EXISTING SERVICES DENOTED WITH (E), EXISTING SERVICE OFFSETS ARE AN APPROXIMATE TO BE VERIFIED BY THE CONTRACTOR.

WARNING

BEWARE OF UNDERGROUND SERVICES

THE LOCATIONS OF UNDERGROUND SERVICES ARE APPROXIMATE TO THEIR EXISTING POSITION. SHOULD BE PROVEN ON SITE. NO GUARANTEE IS GIVEN THAT ALL EXISTING SERVICES ARE SHOWN.

Major Cables exist in the area, if your activities are within Telstra encroachment distances (see duty of care contact 03 9632 9961 at least 2 business days before starting activity.



LEGEND

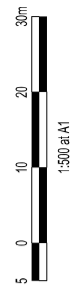

VERSION DETAILS:

REV	DATE	DESCRIPTION	STATUS
A	01/12/2025	PRELIMINARY DETAIL PLAN	PRELIM.
B	13/01/2026	COUNCIL SUBMISSION	PRELIM.
C	25/05/2026	MINOR DRAINAGE AMENDMENTS	PRELIM.
D	22/06/2026	SHARED USER PATHWAY AMENDMENTS	PRELIM.

FLENAME:	P:16691669_58E2 - Design06 - DGN1669-58_R05.dgn		
SCALE:	AS SHOWN		
DRAWN:	C.BAXTER	DATE:	NOV 2025
DESIGNED:	J.POTGIETER	DATE:	NOV 2025
AUTHORISED:	J.POTGIETER	DATE:	NOV 2025



COUNCIL:	CITY OF CASEY		
TITLE:	BROWN PROPERTY GROUP MERIDIAN GREEN - STAGE 58 1525 POUND ROAD - CLYDE NORTH ROAD AND DRAINAGE PLANS DETAIL PLAN & SERVICE OFFSET TABLE		
DRG NO.:	1669_58R05	REV.:	D
		SHEET 05 OF 20	

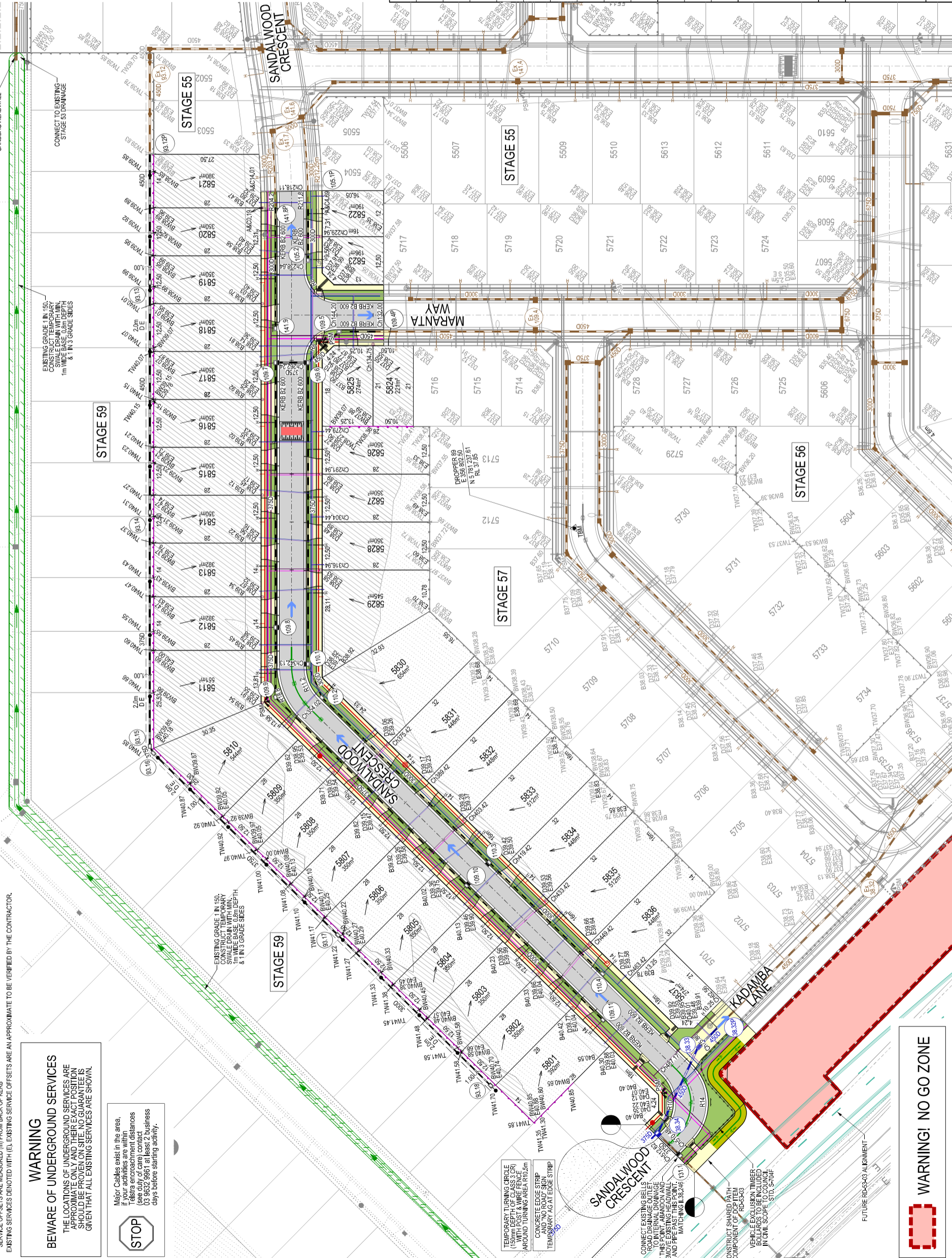

WARNING! NO GO ZONE

