

SERVICE OFFSET TABLE

Location	Gas		ND-Water		Water		Electricity		Telecommunication		Sewer		Lighting	
	Side	Offset (m)	Side	Offset (m)	Side	Offset (m)	Side	Offset (m)	Side	Offset (m)	Side	Offset (m)	Side	Offset (m)
PORTOBELLO BOULEVARD (LOTS 2209-2222)	N	0.00	N	1.05	N	1.55	S	2.25	S	1.55	S	0.80	EW	0.8
PORTOBELLO BOULEVARD (FUTURE LOT)	N	0.00	N	1.05	N	1.55	S	2.25	S	1.55	S	0.80	EW	0.8
COROLLIER STREET	E	2.10	E	2.50	E	2.95	W	2.60	W	1.90	W	0.80	EW	0.8
PAMIR CIRCUIT (LOTS 2216-2219 & 2232-2237)	E	2.10	E	2.50	E	2.95	W	2.60	W	1.90	W	0.80	EW	0.8
PAMIR CIRCUIT (LOTS 2201-2203)	E	2.10	E	2.50	E	2.95	W	2.60	W	1.10	W	0.40	EW	0.8
PAMIR CIRCUIT (LOTS 2206-2210)	E	2.10	E	2.50	E	2.95	W	2.60	W	1.90	W	0.80	EW	0.8
BOYCE CIRCUIT (LOTS 2228-2231)	E	2.10	E	2.50	E	2.95	W	2.60	W	1.10	W	0.40	EW	0.8
BOYCE CIRCUIT (LOTS 2233-2243)	E	2.10	E	2.50	E	2.95	W	2.60	W	2.40	W	1.70	EW	0.8
HAKU WAY	S	2.10	S	2.50	S	2.95	N	2.60	N	1.90	N	0.80	EW	0.8

NOTE: STREET TREES ARE TO BE PLANTED IN THE CENTRE OF ALL VARIETY STRIPS

ROAD LAYOUT TABLE

Road Name	Reserve Width (m)	Road Width (m)		Kerb Type		Verge Width (m)
		Lip to Lip	Inv to Inv	North/West	South/East	
PORTOBELLO BOULEVARD	15.50	9.70	10.00	600.02	600.02	3.20
COROLLIER STREET	15.00	6.40	7.30	600.02	600.02	4.20
PAMIR CIRCUIT (E-W)	14.50	6.40	7.30	600.02	600.02	2.70
PAMIR CIRCUIT (N-S)	14.50	6.40	7.30	600.02	600.02	2.70
BOYCE CIRCUIT	15.00	6.40	7.30	600.02	600.02	4.20
HAKU WAY	15.00	6.40	7.30	600.02	600.02	4.20

NOTE:
 1. NO DRAINAGE WORKS SHALL COMMENCE UNTIL THE CONTRACTOR CONFIRMS THE INVERT LEVEL OF ALL EXISTING DRAINS, AND CONFIRMS IN WRITING WITH THE ENGINEERING SUPERVISOR.
 2. REFER TO CHARLOTTES TUCKERS & HARDYS ROAD INTERSECTION PLANS FOR FURTHER INFORMATION ON INTERFACE WITH STAGE 2 DESIGN.
 3. LOT GRADING WITHIN THE SUPERLOT TO BE MINIMUM 1:100 TO MATCH EXISTING SURFACE FROM THE CHANNEL.

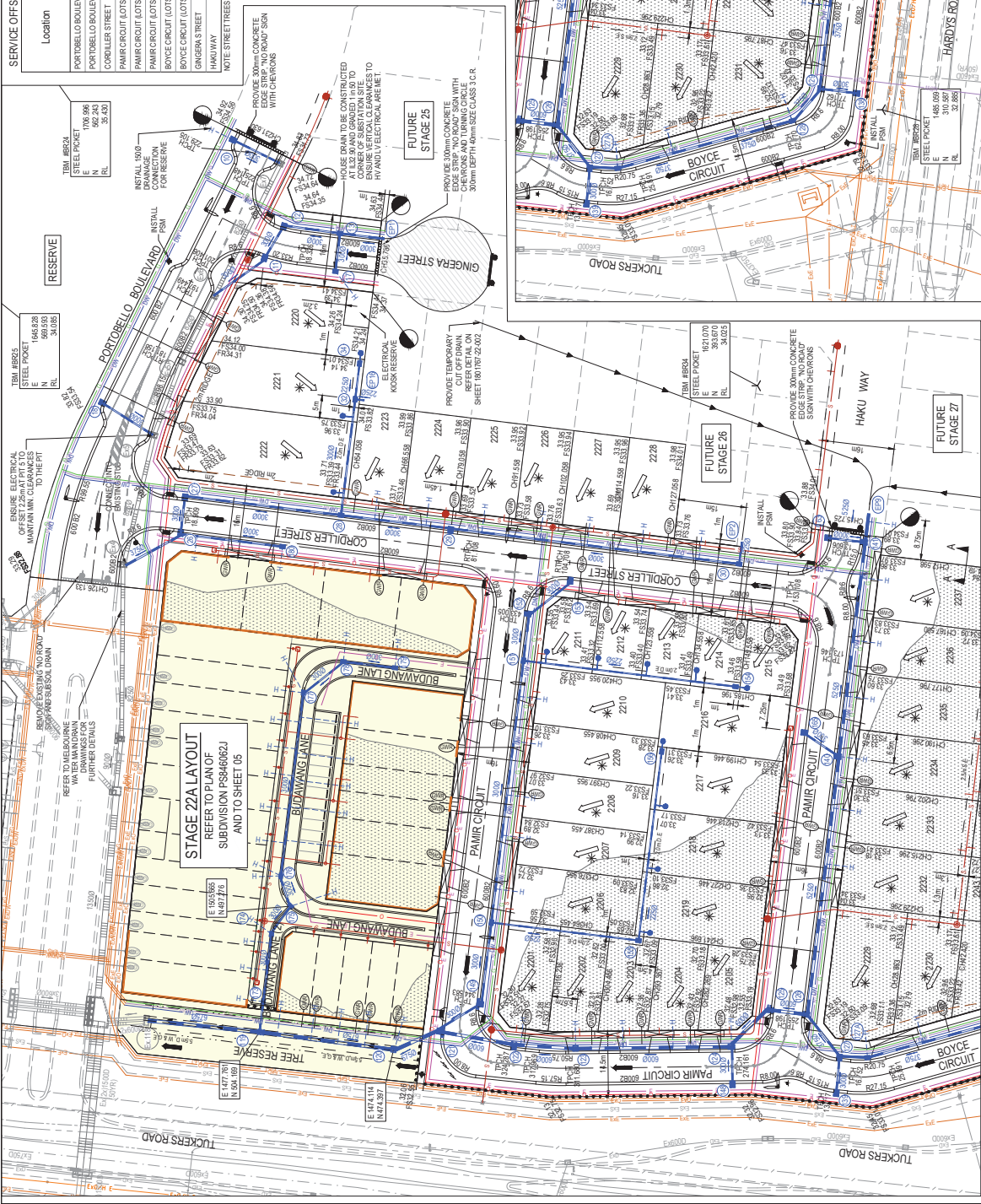

LEGEND - LANDSCAPE

- STORMWATER DRAIN
- MELBOURNE WATER DRAIN & PIT
- SWALE DRAIN
- SEWER & MAINTENANCE STRUCTURES
- HOUSE DRAIN
- WATER DRAIN
- ELECTRICITY (UNDERGROUND)
- ELECTRICITY (OVERHEAD)
- OPTIC FIBRE
- EXISTING SEWER
- EXISTING HOSE DRAIN
- EXISTING SWALE DRAIN
- WATER
- RECYCLED WATER

LEGEND - UTILITIES

- EXISTING STORMWATER DRAIN
- EXISTING ELECTRICITY UNDERGROUND
- EXISTING ELECTRICITY OVERHEAD
- EXISTING GAS
- EXISTING OPTIC FIBRE
- EXISTING TELECOMMUNICATIONS
- EXISTING RECYCLED WATER
- EXISTING SEWER
- EXISTING HOSE DRAIN
- EXISTING SWALE DRAIN
- EXISTING WATER
- RECYCLED WATER

LEGEND - ROADWORK

- EXISTING SURFACE LEVEL
- EXISTING BUILDING LEVEL
- FINISHED ROUGE LINE LEVEL
- TOP OF RETAINING WALL
- BOTTOM OF RETAINING WALL
- RETAINING WALL
- PAVEMENT TREATMENT
- ZERO LOT LINES
- EXISTING TREE TO BE REMOVED
- PERMANENT SURVEY MARK
- PROPOSED DRIVEWAY
- EX STRUCTURAL FILL > 200mm DEEP
- TACTILE PAVERS (INDICATIVE ONLY)

FOR CONTINUATION REFER TO RIGHT

FOR CONTINUATION REFER TO LEFT

STAGE 22A LAYOUT
 REFER TO PLAN OF SUBDIVISION PSB4-0062J AND TO SHEET 05

WARNING
 BEWARE OF UNDERGROUND SERVICES
 No guarantee is given that all existing services are shown. Locate all underground services prior to start of works.
 DIAL 1100 BEFORE YOU DIG
 www.1100.com.au

ISSUED FOR CONSTRUCTION

SECTION A-A
 NOT TO SCALE

Scale: 1:500 @ A1

North Arrow: N

Project: MERIDIAN CENTRAL ESTATE
Stage: STAGE 22 & 22A
City: CITY OF CASEY
Layout Plan: STAGE 22

Client: Beveridge Williams
Designer: M. FELICIANO
Drawn: M. FELICIANO
Checked: M. FELICIANO
Date: 23/07/2020
Project No.: PSB07133A

Sheet: 04 of 30
Scale: 1:500 @ A1
Project No.: 1801767
Stage No.: 22
Drawn No.: 010
Rev.: H