

**WARNING**  
BEWARE OF UNDERGROUND SERVICES

THE LOCATIONS OF UNDERGROUND SERVICES ARE APPROXIMATE ONLY AND THEIR EXACT POSITION SHOULD BE PROVEN ON SITE. NO GUARANTEE IS GIVEN THAT ALL EXISTING SERVICES ARE SHOWN.

Major Cables exist in the area, if your activities are within Telstra encroachment distances (see duty of care) contact 03 9632 9961 at least 2 business days before starting activity.



**SERVICE OFFSETS**

Street	Gas	NDW	Water	Comms	Elec.	Lighting	Sewer
CLARA DRIVE	S 2.00	S 2.60	S 3.30	S 0.40	S 4.55	0.90 BOK	S 1.00 1.00(E)
BROMELIAD STREET	N 2.00	N 2.50	N 3.00	S 1.85	S 2.50	0.90 BOK	N S 1.00(E) 1.00(E)
KALTU STREET	N 2.00	N 2.50	N 3.00	S 1.80	S 2.40	0.90 BOK	N S 1.00(E) 1.00(E)
BAMBUSA WAY	E 2.00	E 2.50	E 3.00	W 1.85	W 2.40	0.90 BOK	E W 1.00 1.00(E)
BALCARRA STREET	E 2.00	E 2.50	E 3.00	W 1.85	W 2.50	0.90 BOK	E 1.00

SERVICE OFFSETS ARE MEASURED (m) FROM THE TITLE BOUNDARY UNLESS OTHERWISE SPECIFIED  
\* SERVICE OFFSETS ARE MEASURED (m) FROM BACK OF KERB  
EXISTING SERVICES DENOTED WITH (E). EXISTING SERVICE OFFSETS ARE AN APPROXIMATE TO BE VERIFIED BY THE CONTRACTOR.

**LEGEND**

- FOOTPATH
- VEHICULAR CROSSOVER
- ROAD PAVEMENT, KERB AND CHANNEL
- ELECTRICITY TELECOMMUNICATION CONDUITS (REFER TO APPROVED ELECTRICAL AND COMMS PLAN)
- GAS DRINKING WATER NON DRINKING WATER CONDUITS
- ELECTRICITY MAIN
- TELECOMMUNICATION MAIN
- GAS MAIN
- DRINKING WATER MAIN
- NON DRINKING WATER MAIN
- SEWER MAIN, MAINTENANCE STRUCTURES AND SEWER PROPERTY BRANCHES
- PROPOSED DRAINAGE, PIT, HOUSE DRAIN AND PROPERTY INLET
- EXISTING DRAINAGE AND PIT AND FUTURE DRAINAGE AND PIT
- MELBOURNE WATER SCHEME DRAINAGE AND PIT (COUNCIL ASSET)
- MELBOURNE WATER SCHEME DRAINAGE AND PIT (MELBOURNE WATER ASSET)
- DRAINAGE PIT NUMBER
- PROPOSED CUT AREAS
- PROPOSED FILL AREAS
- E00.00 EXISTING SURFACE LEVEL
- D00.00 DESIGN SURFACE LEVEL
- B00.00 TOP OF BATTER LEVEL
- P00.00 PADS LEVEL
- FT STREET NAME SIGN
- LOT SLOPE DIRECTION
- PERMANENT SURVEY MARK
- TEMPORARY BENCH MARK
- RETAINING WALLS
- KERB TRANSITION
- OVERLAND FLOW PATH

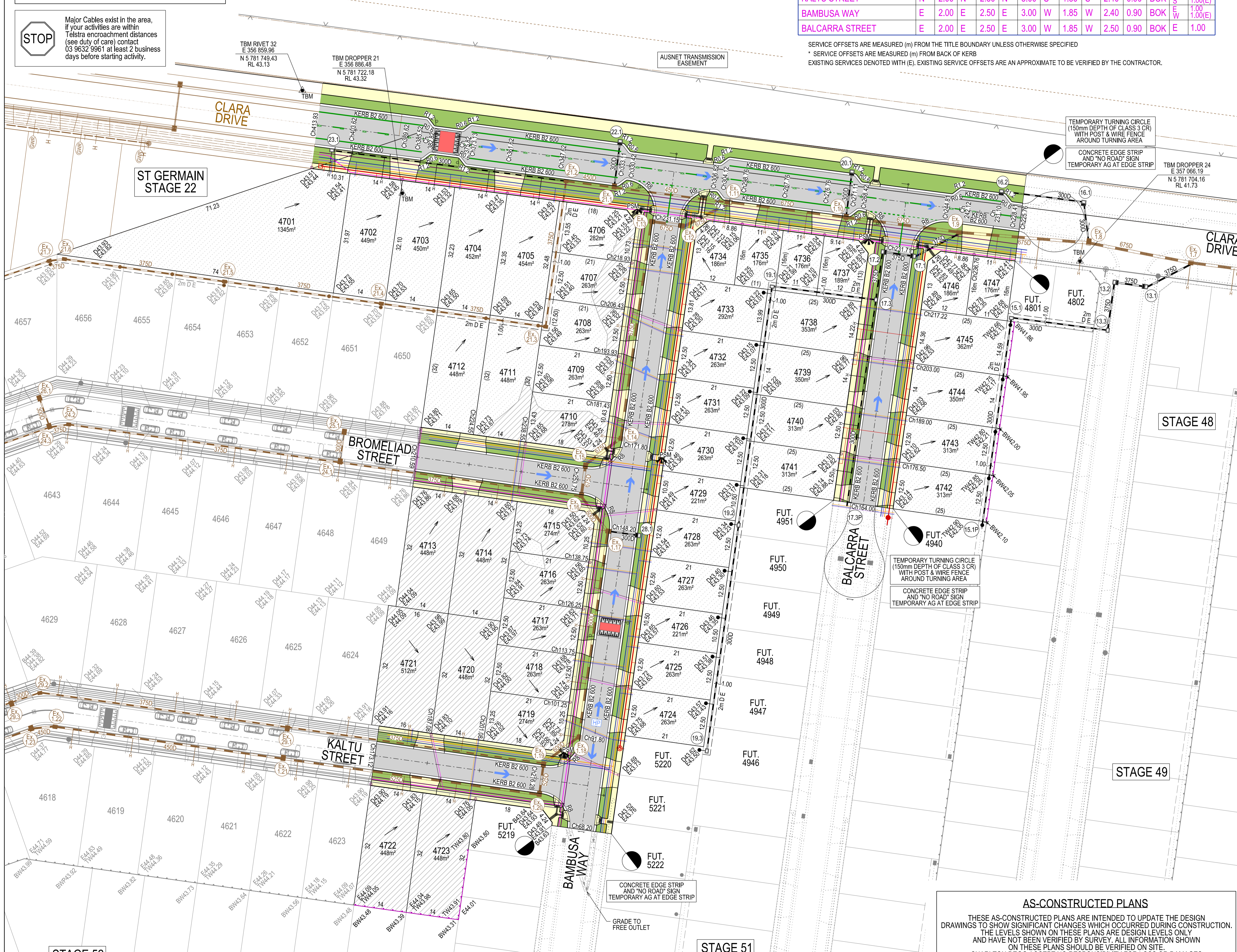
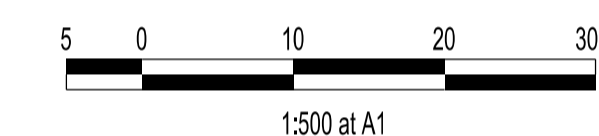

**VERSION DETAILS:**

REV	DATE	DESCRIPTION	STATUS
A	28/03/2023	COUNCIL SUBMISSION	PRELIMINARY
B	11/05/2023	VEHICLE CROSSINGS AMENDED FOR LOTS 4711, 4714, 4720 & 4723 & MINOR LOT LEVEL AMENDMENTS	PRELIMINARY
C	30/05/2023	RETAINING WALL LOT LEVELS AMENDED	PRELIMINARY
D	30/08/2023	SECTION OF FOOTPATH NOTED TO BE BONDED, FUT, SEWER & WATER TAPPINGS REMOVED FROM STAGE	PRELIMINARY
E	12/01/2024	COUNCIL COMMENTS 22/12/24	PRELIMINARY
F	31/01/2024	SHARED PATH INCLUDED IN STAGE 47 R&D WORKS	PRELIMINARY
G	15/04/2024	AS CONSTRUCTED PLANS	AS CON

FILENAME: P:\1669\1669\_47\E2 - Design\6 - DGN\1669-47\_R04.dgn

DRAWN: C.BAXTER DATE: FEB 2023 SCALE: AS SHOWN

DESIGNED: J.POTGIETER DATE: FEB 2023 DATE PRINTED: 15/04/2024

AUTHORISED: T.SMITH DATE: FEB 2023

SUITE 1, LEVEL 1, 84 MT ELIZA WAY, MT ELIZA VIC 3930  
www.charltondegg.com.au

COUNCIL: CITY OF CASEY

TITLE: BROWN PROPERTY GROUP  
MERIDIAN GREEN - STAGE 47  
1525 POUND ROAD - CLYDE NORTH  
ROAD AND DRAINAGE PLANS  
DETAIL PLAN & SERVICE OFFSET TABLE

**AS-CONSTRUCTED PLANS**

THESE AS-CONSTRUCTED PLANS ARE INTENDED TO UPDATE THE DESIGN DRAWINGS TO SHOW SIGNIFICANT CHANGES WHICH OCCURRED DURING CONSTRUCTION. THE LEVELS SHOWN ON THESE PLANS ARE DESIGN LEVELS ONLY AND HAVE NOT BEEN VERIFIED BY SURVEY. ALL INFORMATION SHOWN ON THESE PLANS SHOULD BE VERIFIED ON SITE. CHARLTON DEGG ACCEPT NO RESPONSIBILITY FOR LOSS OR DAMAGES FROM THE INAPPROPRIATE USAGE OF THESE PLANS.

CONCRETE EDGE STRIP AND "NO ROAD" SIGN TEMPORARY AG AT EDGE STRIP

GRADE TO FREE OUTLET

STAGE 52

STAGE 51

STAGE 49

STAGE 48